

TRADITION

SERIES

THE TRADITION 76C

TRA28764C | 4 beds | 2 baths | 2,001 sq. ft. | 28x76

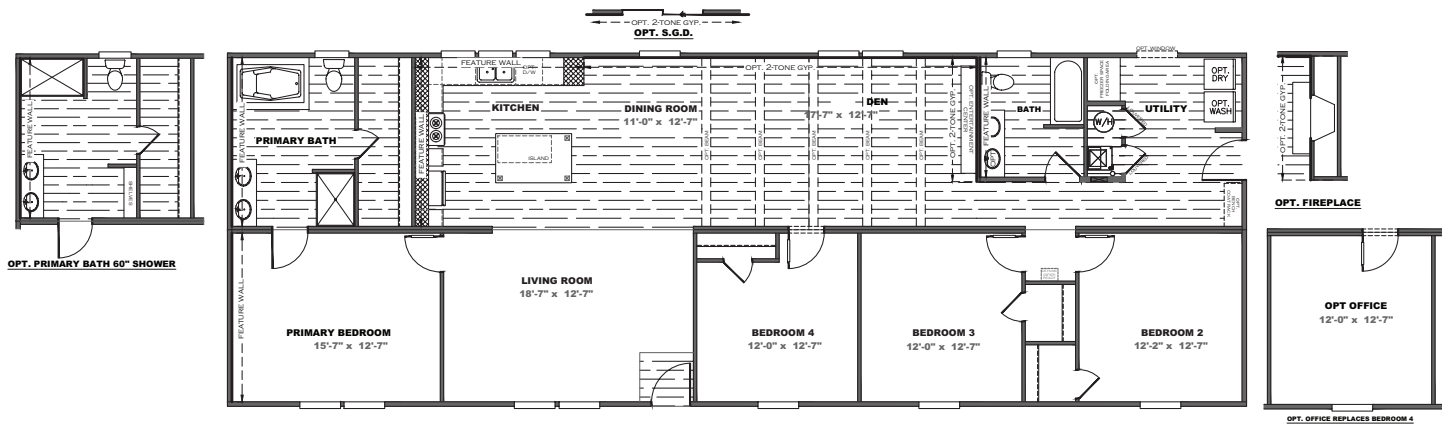

STANDARD FEATURES

- 8' Flat Ceilings
- 2x6 16 O.C. Floor Joists
- 30" Overhead DuraCraft® Cabinets
- Traditional Cabinet Doors (w/Hidden Hinges)
- Kitchen Island w/Overhang
- Double Primary Bath Sinks
- Glamour Bath w/Fiberglass Montrose Tub
- 6 Panel Steel Front Door
- Cottage Rear Door w/9 Light Window
- 2 Panel Arched Interior Doors
- Argon Gas Low-E Windows
- Beauflor Floor Vinyl
- ecobee Smart Thermostat® Lite 5
- Double Marriage Wall Construction
- Exterior GFI Recept (Rear Sidewall)
- 5.2 lb. Rebond Pad
- Vinyl Entry
- 25 oz. R2X Stain Resistant Carpet
- Dishwasher
- Smooth Top Range
- SmartComfort® Furnace by Carrier®
- Kwikset® Smart Key Security
- Frigidaire® Appliances
- Rheem® Water Heater
- Pfister® Faucets



STANDARD WITH

- Whole House Ventilation
- Rheem® Hybrid Heat Pump Water Heater
- Argon Gas Low-E Windows
- Exterior Door Insulation
- ecobee® Thermostat
- SmartComfort® Furnace by Carrier®
- LED Lighting
- Solar and Wind Ready
- Dehumidifier Ready (Zone 1 STD)
- Pfister® Water Saving Fixtures
- Zero Ready Insulation Package
- Sealed Duct System
- Energy Star Frigidaire® Dishwasher and Refrigerator (If Needed)
- ENERGY STAR® Ventilation Fans
- ENERGY STAR® Ready

AVAILABLE OPTIONS

(Some Options Not Available on Display Units)

- | | | |
|---|---|--|
| <input type="checkbox"/> White Board and Batten | <input type="checkbox"/> Line Base Center Shelves | <input type="checkbox"/> Stone Fireplace |
| <input type="checkbox"/> Columns | <input type="checkbox"/> Upgrade Cabinet Pulls Kitchen /Throughout | <input type="checkbox"/> Washer/Dryer |
| <input type="checkbox"/> Awning Above LR Window | <input type="checkbox"/> Gas Furnace | <input type="checkbox"/> Optional Office (Where Applicable) |
| <input type="checkbox"/> Craftsmen Shutters | <input type="checkbox"/> Exterior GFI Recept (Front) | <input type="checkbox"/> Utility Room Door |
| <input type="checkbox"/> OSB Wrap | <input type="checkbox"/> Outside Faucet (Front/Rear) | <input type="checkbox"/> Wire Shelving Over Washer and Dryer |
| <input type="checkbox"/> 2x6 Sidewalls w/R21 Insulation | <input type="checkbox"/> Water Cut-Off Valves t/o | <input type="checkbox"/> Optional Primary Bath Door |
| <input type="checkbox"/> Dormer | <input type="checkbox"/> 50 Gallon Water Heater | <input type="checkbox"/> Flash Package |
| <input type="checkbox"/> Wind Zone II w/OSB Wrap | <input type="checkbox"/> Ceramic Sinks | |
| <input type="checkbox"/> Wind Zone III w/OSB Wrap | <input type="checkbox"/> Fiberglass Tubs/Showers | |
| <input type="checkbox"/> Sliding Glass Door | <input type="checkbox"/> Shower Only w/Linen Shelves (Primary) | ADDITIONAL VINYL FLOORING |
| <input type="checkbox"/> Drip Edge | <input type="checkbox"/> Shower Only Hall Bath | <input type="checkbox"/> Throughout |
| <input type="checkbox"/> Front Storm Door (Ship Loose) | <input type="checkbox"/> ENERGY STAR® Ceiling Fans (LR/MBR) | <input type="checkbox"/> Living Room |
| <input type="checkbox"/> Recessed Frame | <input type="checkbox"/> Chair Rail (DR) | <input type="checkbox"/> Primary Bedroom |
| <input type="checkbox"/> 2" Mini Blinds | <input type="checkbox"/> Wire & Brace (Bedrooms) | <input type="checkbox"/> Secondary Bedrooms |
| <input type="checkbox"/> Stainless Steel Appliances | <input type="checkbox"/> Double Shelving in Closets | <input type="checkbox"/> #'s _____ |
| <input type="checkbox"/> Microwave | <input type="checkbox"/> Shoe Racks (Where Applicable) | |
| <input type="checkbox"/> Side-By-Side Refrigerator | <input type="checkbox"/> Entertainment Center with Cabinets | OTHER |
| <input type="checkbox"/> Gas Range | <input type="checkbox"/> Entertainment Center with Half-Stack Stone | <input type="checkbox"/> _____ |
| <input type="checkbox"/> Icemaker | <input type="checkbox"/> Entertainment Center with Stone Columns | <input type="checkbox"/> _____ |
| <input type="checkbox"/> White Farm House Sink with Sprayer | | |
| <input type="checkbox"/> Stainless Steel Apron Sink | | |
| <input type="checkbox"/> Finished Overhead Cabinets | | |

DECOR SELECTION

WALL BOARDS

COUNTERTOPS

FLOOR VINYL

SIDING

CABINETS

ISLAND

CARPET

SHUTTERS

Please refer to our Design Center or the Product Book for Colors



Customer Name _____

Customer Phone # _____

Customer Email _____

Customer Signature _____