

Clayton appalachia

— BREEZE SERIES —

FARMHOUSE BREEZE 72



MVP28724A | 4/5 beds | 2 baths | 1,896 sq. ft. | 28x72

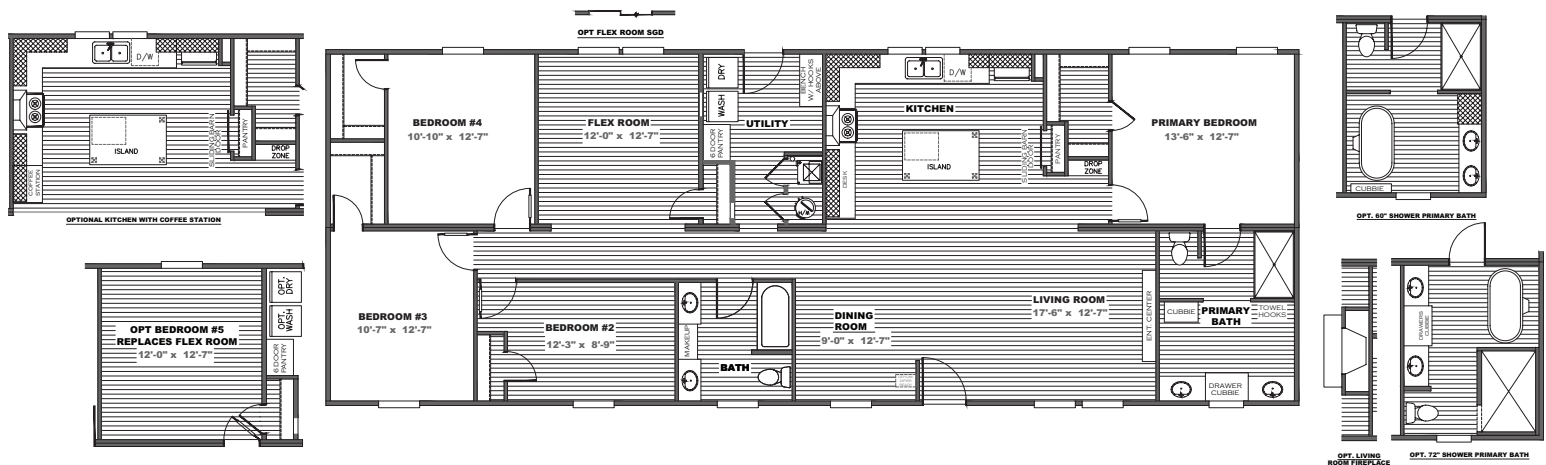

OPTIONS

- ☐ Grey Exterior Package
- ☐ Bronze Windows
- ☐ OSB Wrap
- ☐ 2x6 Sidewalls w/ R21 Insulation
- ☐ Wind Zone II w/OSB
- ☐ Wind Zone III w/OSB
- ☐ Front Storm Door (Ship Loose)
- ☐ Recessed Frame
- ☐ Hardi Fascia
- ☐ 2" Mini Blinds
- ☐ Microwave
- ☐ Side by Side Refrigerator
- ☐ Smooth Top Range
- ☐ Gas Range
- ☐ Icemaker
- ☐ Stainless Steel Apron Sink
- ☐ Finished Overhead Cabinets
- ☐ Built-in Coffee Station with Microwave (Select Models)
- ☐ Lined Base Center Shelves
- ☐ Exterior GFI (Front)
- ☐ Water Cut Offs Throughout
- ☐ Gas Furnace
- ☐ Exterior Faucet (Front/Rear)
- ☐ Ceramic Sinks
- ☐ Elongated Commodes
- ☐ Fiberglass Tubs/Showers
- ☐ Glamour Bath with Tub
- ☐ Six 3 Tile Walk in Shower w/ Freestanding Tub
- ☐ Six 3 Tile Walk in Shower Only
- ☐ Ceiling Fan LR/PBR/DEN
- ☐ Stone Fireplace
- ☐ 50 Gallon Hybrid Heat Pump Water Heater

- ☐ Optional Office (Where Applicable)
- ☐ Wire Shelving Utility Room

OTHER

- ☐ _____
- ☐ _____

SIDING

- ☐ _____

ADDITIONAL FLOORING

- ☐ Throughout
- ☐ Primary Bedroom
- ☐ Secondary Bedrooms: #s _____



- Whole House Ventilation
- Rheem Hybrid Heat Pump Water Heater
- Argon Gas Low E Windows
- Insulated Exterior Doors
- Ecobee Thermostat
- Smart Comfort By Carrier
- LED Lighting
- Solar Ready
- Dehumidifier Ready (Zone 1 STD)
- Pfister Water Saving Fixtures
- Zero Ready Insulation Package
- Sealed Duct System
- Energy Star Dishwasher and Refrigerator (If Needed)
- Energy Star Ventilation Fans
- Energy Star Ready

Customer Name _____ County and State _____